

COPY RIGHT OF THIS DRAWING BELONGS TO
 M/S S. S. INFRASTRUCTURE PROJECT CONSULTANTS PVT. LTD.
 AND SHOULD NOT BE USED FOR ANY PURPOSE OTHER THAN SPECIFIED
 WITHOUT PRIOR PERMISSION.

NORTH :

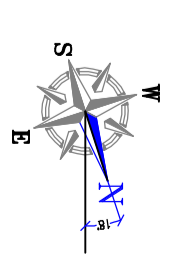

FOR TENDER ONLY

— EXISTING WALL LINE
 — PROPOSED WALL LINE

SCHEDULE OF OPENING

S.NO	MKD	SIZE	G.FLRF.FLR
1	D1	2000 X 2100	3
2	D2	1000 X 2100	8
3	D3	800 X 2100	4
4	W	1000 X 1800	17
5	W1	1000 X 1200	4
6	W2	600 X 1800	2
7	W3	750 X 1800	6
8	FG	1000 X 1800	5
9	V	600 X 1200	3
10	G	2300 X 5700	1
11	AD	2000 X 2600	3
12	V1	2000 X 750	1

AREA DETAILS

GROUND FLOOR AREA : 321.56SQMT
 PORTICO AREA : 34.65SQMT
 FIRST FLOOR AREA : 402.32SQMT
 TOTAL AREA : 758.53SQMT

PROJECT :
 EXTENSION OF MET. LAB BUILDING
 AT A.R.C.I. BALAPUR.

TITLE :
 FIRST FLOOR PLAN

CLIENT :
 A.R.C.I. BALAPUR

CONSULTANTS :
 A.R.C.I. BALAPUR

**S.S. INFRASTRUCTURE
 PROJECT CONSULTANTS PVT.LTD.**
 # 25 & 9, JABBAR BUILDINGS,
 BEGUMPET, HYDERABAD-16
 Ph: +91 40 66310954, 66310240
 FAX No: +91 40 66312949.
 email: ssipcpl@gmail.com

DATE : 02.06.14 SHEET NO.:

DEALT BY : M.GANESH

ARCHITECT : A.V.LAKSHMI

PRINCIPAL CONSULTANT: S.S.RAO

02

DRG NO.: SSIPCPL/ARCI/METLAB/FF/AD-02

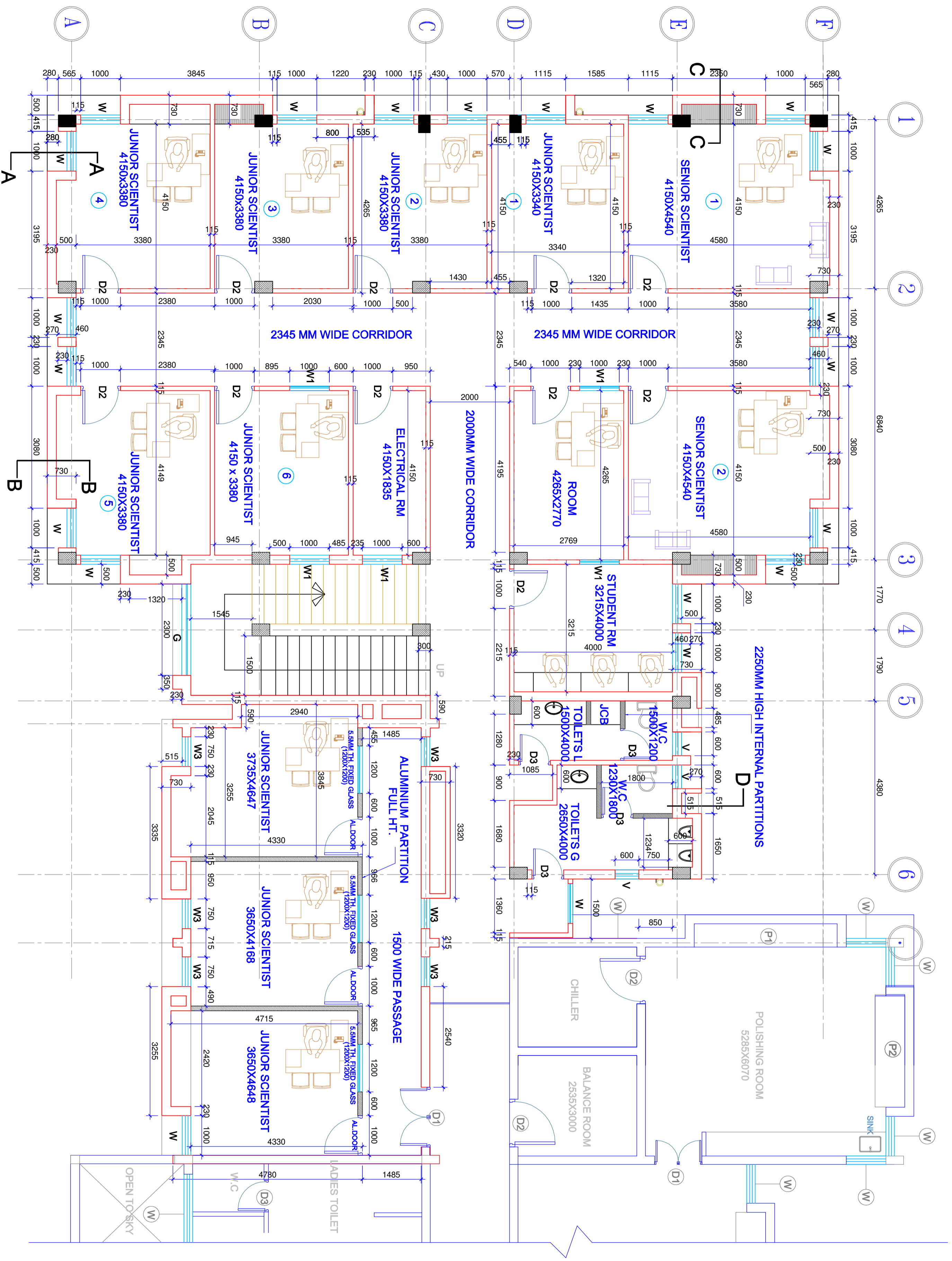

Grid lines: A, B, C, D, E, F, 1, 2, 3, 4, 5, 6, 7, 8, 9, 10, 11, 12