

COPY RIGHT OF THIS DRAWING BELONGS TO
M/S S.S INFRASTRUCTURE PROJECT CONSULTANTS P.L.L.D.
AND SHOULD NOT BE USED FOR ANY PURPOSE OTHER THAN SPECIFIED
WITHOUT PRIOR PERMISSION.

NORTH :

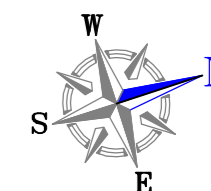

FOR TENDER ONLY

JOINERY SCHEDULE

TYPE	NAME	SIZE	NO
PURE POLYESTER COATED ALUMINIUM FRAMES	AD1	2500x2600	1
WOODEN DOORS	D1	1500x2100	3
WOODEN DOORS	D2	900x2100	1
GI DOOR	CD1	2000x2600	2
GI DOOR	CD2	1000x2100	1
PURE POLYESTER COATED ALUMINIUM FRAMES	FG	1800x1700	3
	WG	1800x1700	1
	W1	1800x1700	10
	W2	1200x1700	1
ROLLING SHUTTER	RS1	3000x3000	1
	RS2	2500x3000	1

AREA : 420.00 SQM

PROJECT :

PROPOSED EXTENSION OF CMD BUILDING
AT A.R.C.I. BALAPUR.

TITLE :

GROUND FLOOR PLAN

CLIENT :

A.R.C.I, BALAPUR

CONSULTANTS :

S.S.INFRASTRUCTURE
PROJECT CONSULTANTS Pvt.Ltd.
25 & 9 , JABBAR BUILDINGS,
BEGUMPET, HYDERABAD-16
Ph : +91 40 663 10954, 663 10240
FAX No : +91 40 663 12949.
email: sslpcpl@gmail.com

DATE : 02-06-14 SHEET NO:

DEALT BY : M.GANESH

ARCHITECT : A.V.LAKSHMI

PRINCIPAL CONSULTANT: S.S.RAO

02

DRG.NO : SSLPCPL / ARCI / CMD / PLAN AD -02

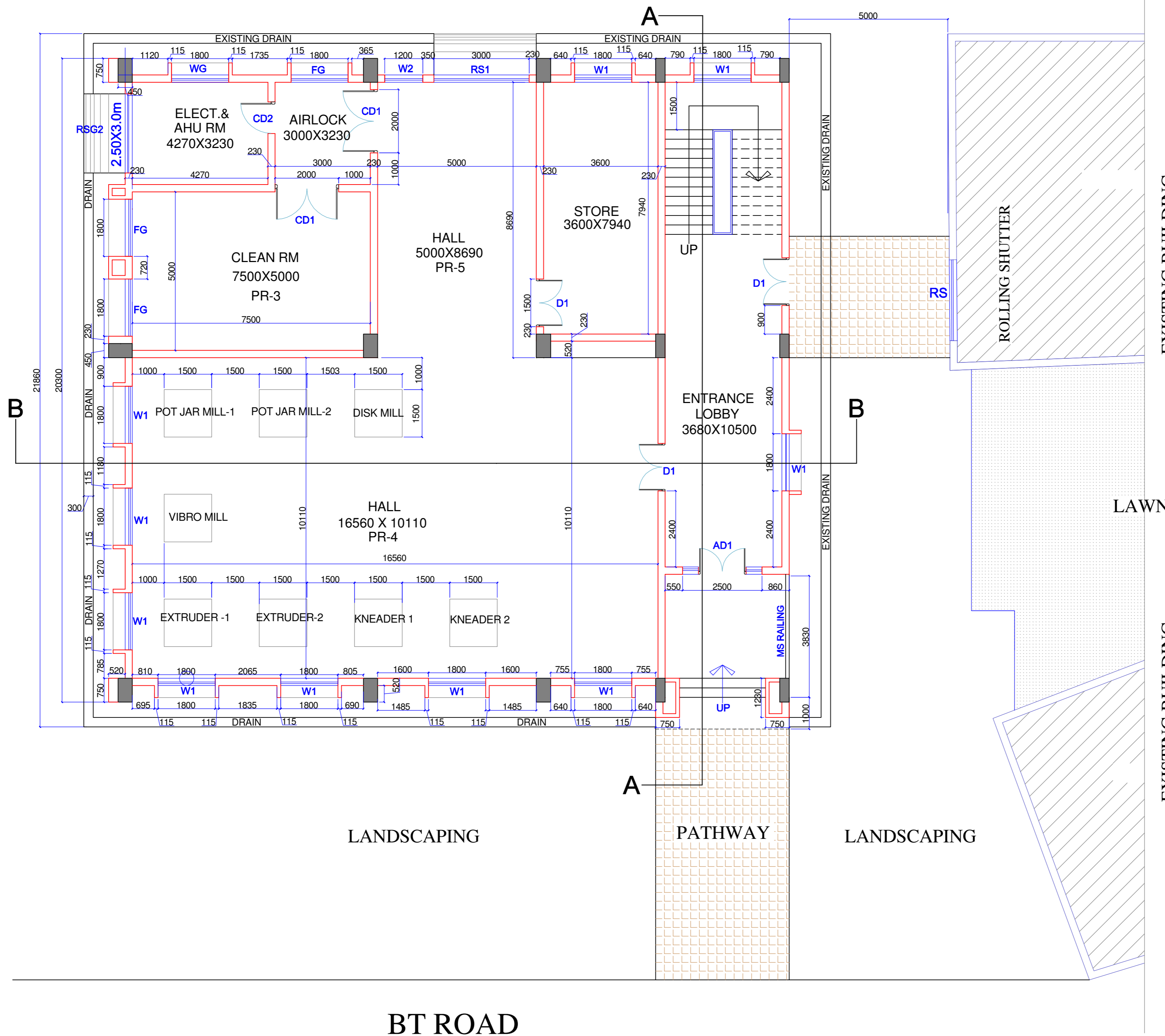

BT ROAD